

## N-0414 - Cocherón SIMPLE con cubierta "diente de sierra" Escala N (1:160)



Despiece

Instrucciones de montaje

Planos

# 1 - Despiece

## Cartón corrugado 0,4 mm

---

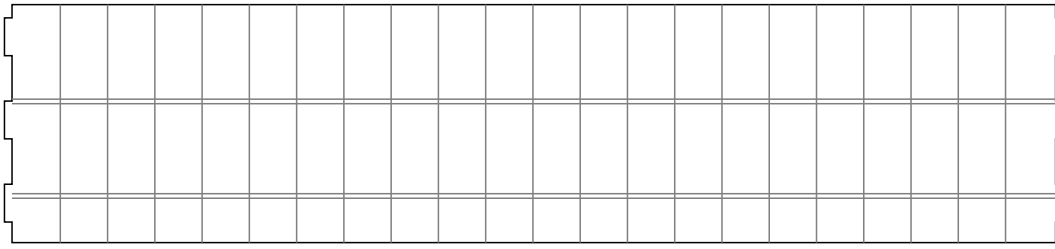

5 x 5 unidades

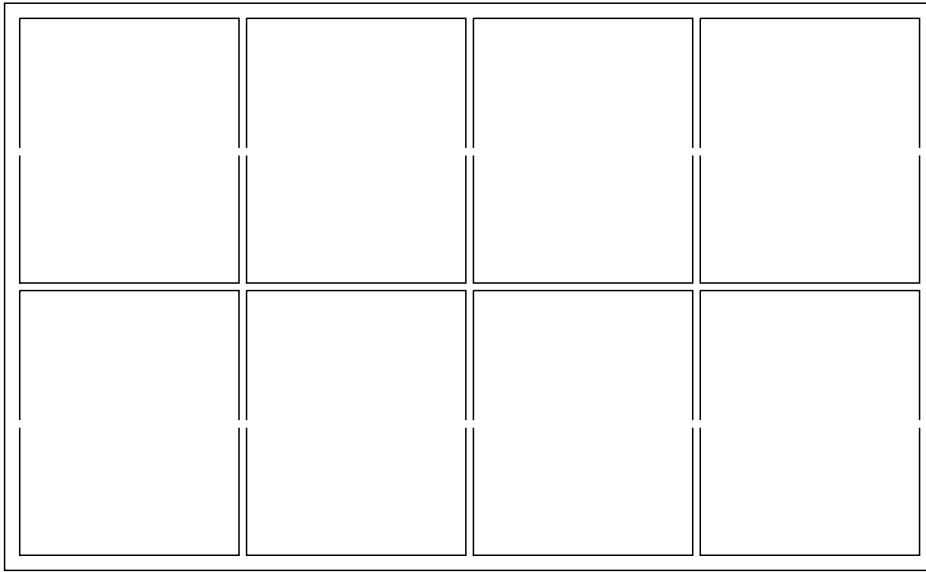

37 x 8 unidades

## Cartón 2 mm

---

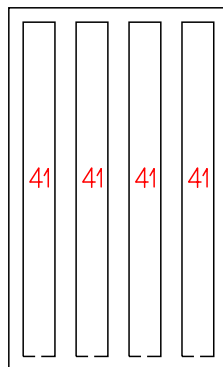
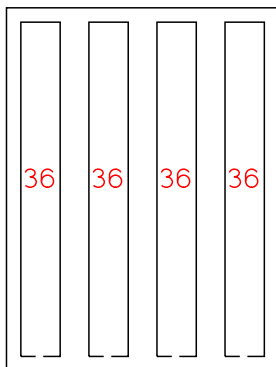
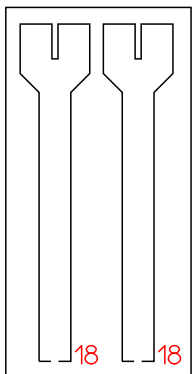

# Cartón 1 mm

---

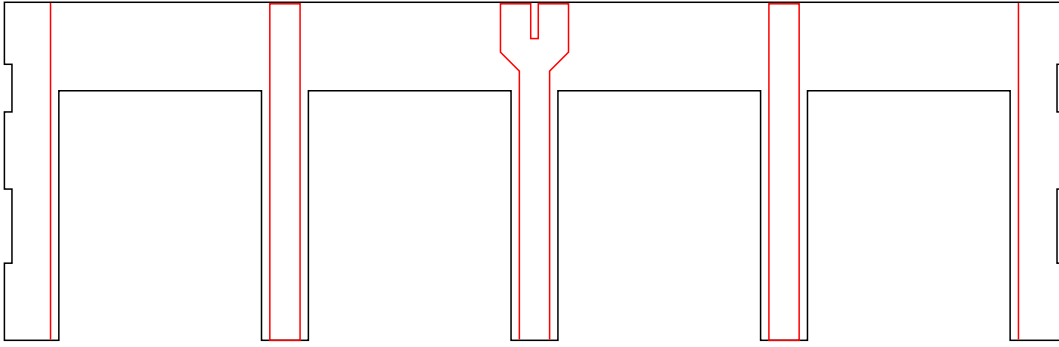

01 x 2 uds.

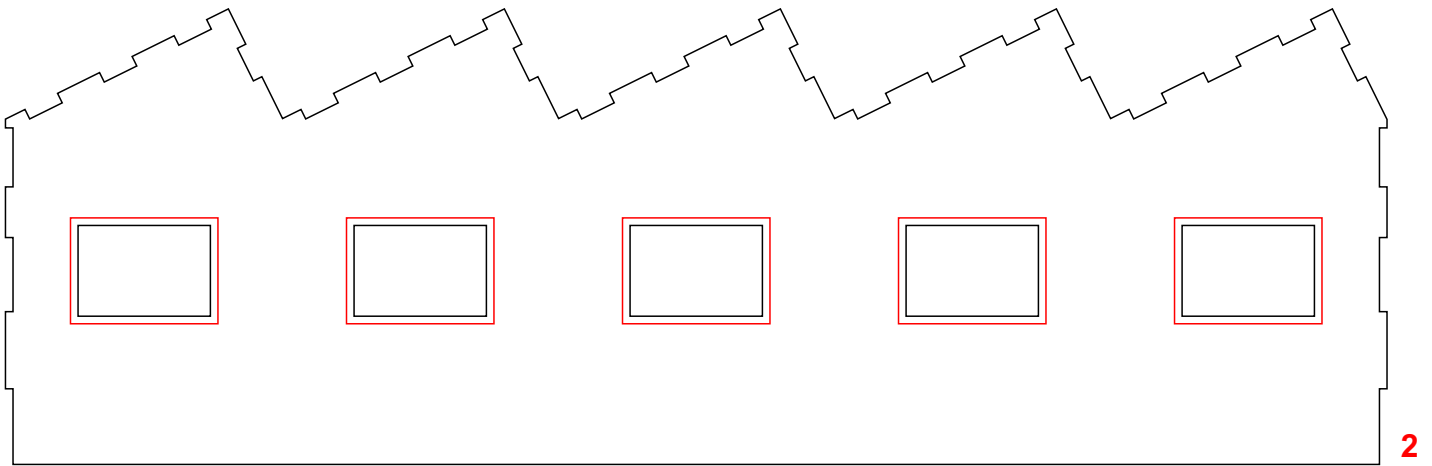

2

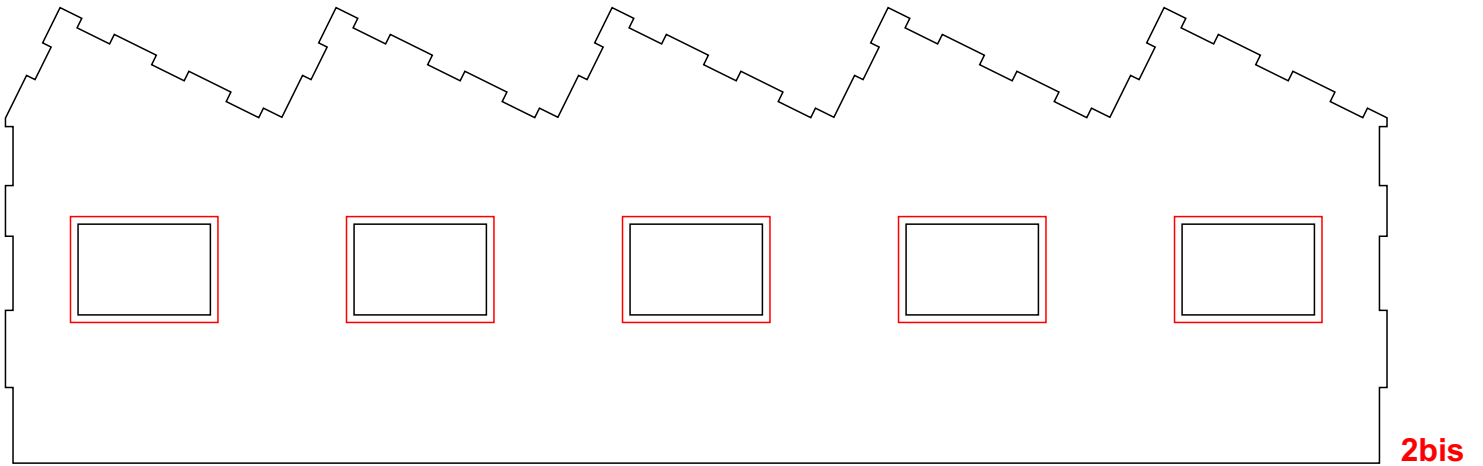

2bis

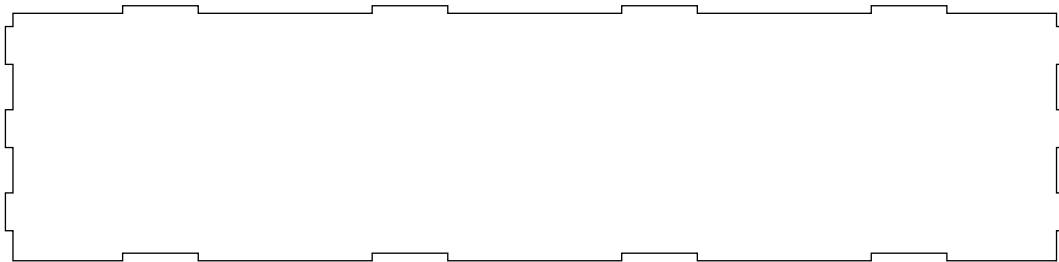

4 - x4 uds.

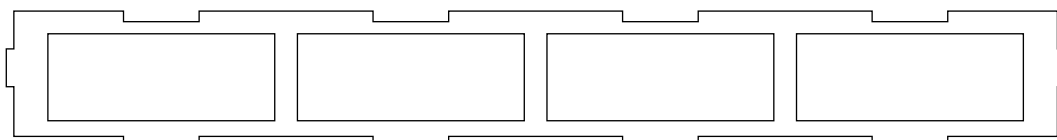

9 - x4 uds.

# Cartón 1 mm

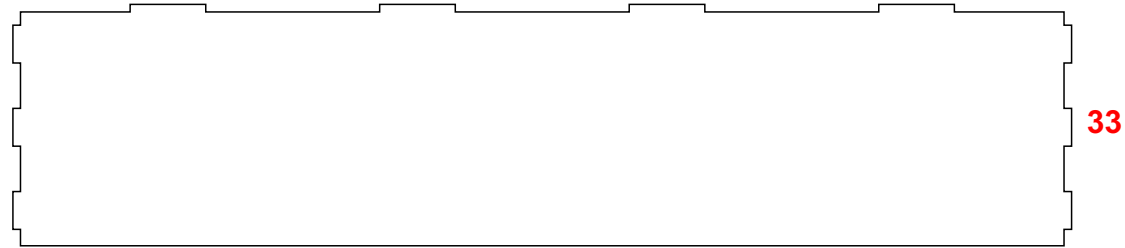
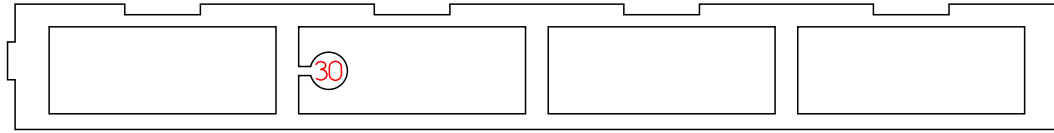
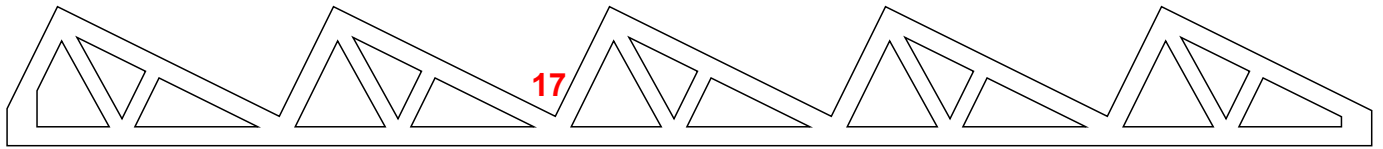

# Cartulina gris 0,25 mm

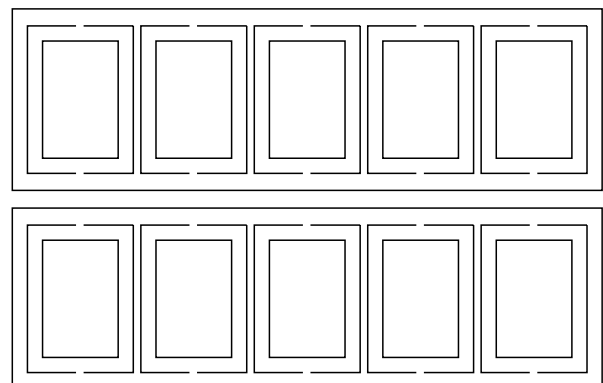
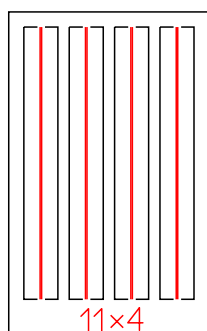
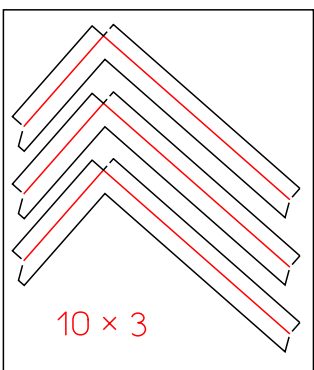
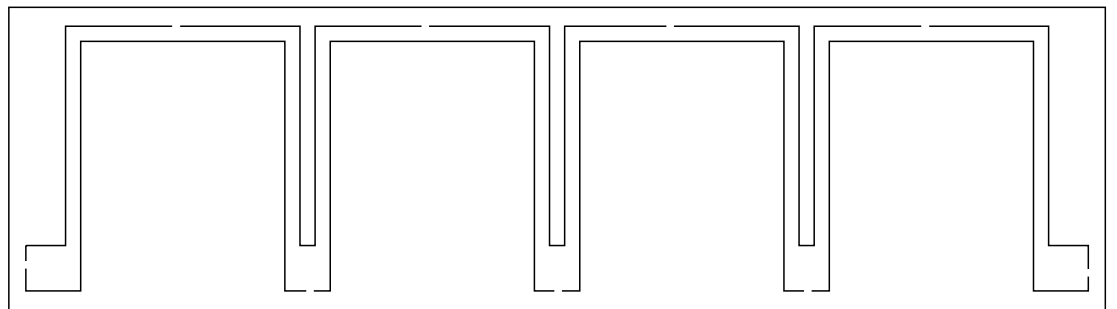
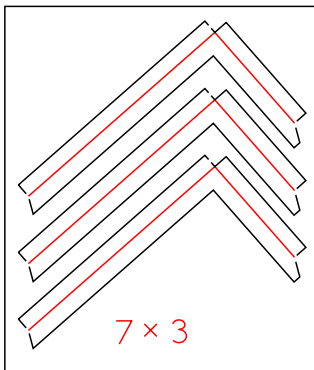
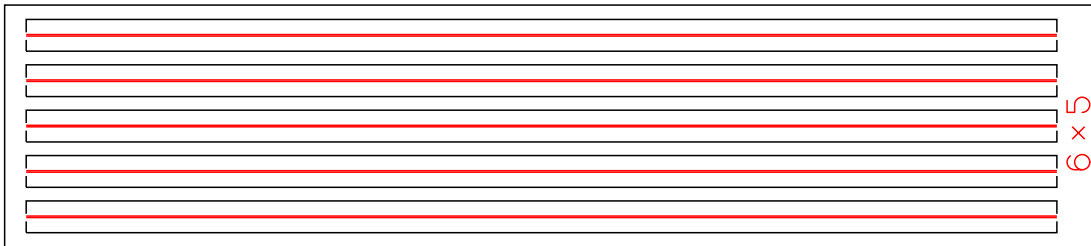
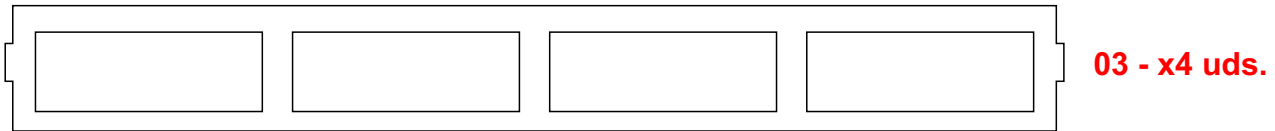

# Cartulina gris 0,25 mm

---

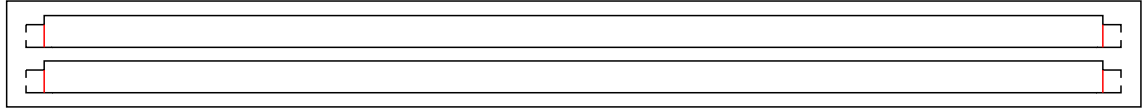

**BL20-C025G**  
14-C025Gx2

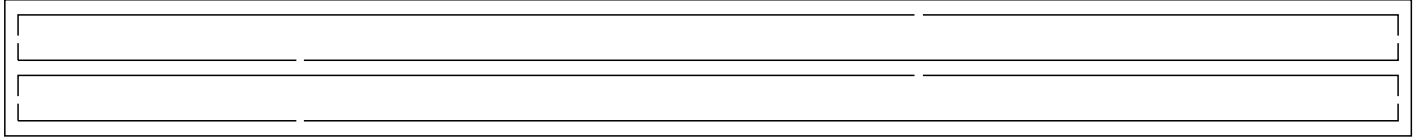

**BL21-C025G**  
15-C025Gx2

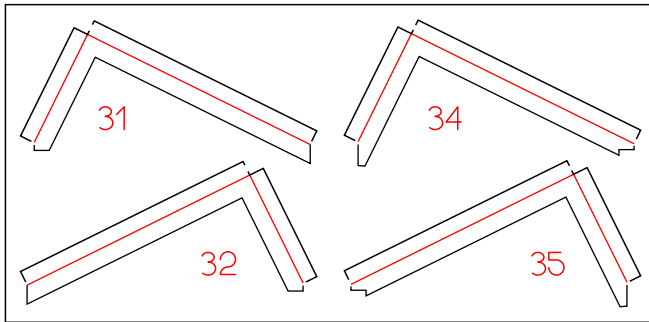

**BL22-C025G**

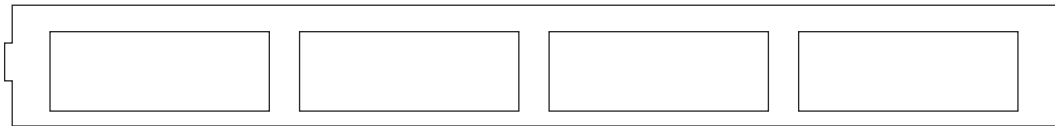

**38-C025G**

# Acetato trasparente

---

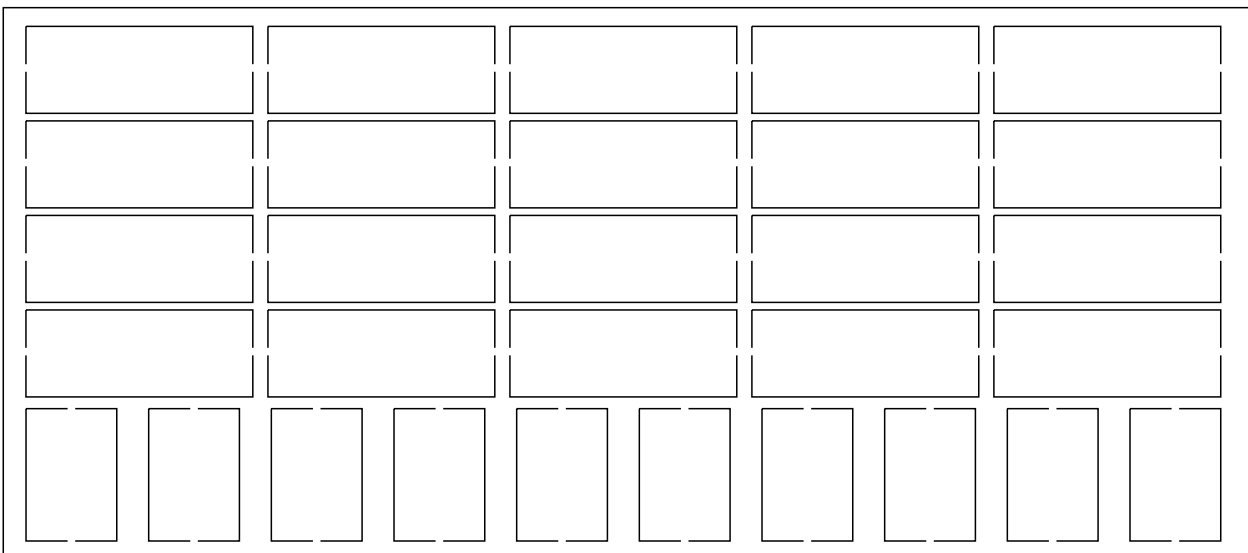

**BL23-ACT**  
12-ACTx10 16-ACTx20

## 2 - Manual de montaje

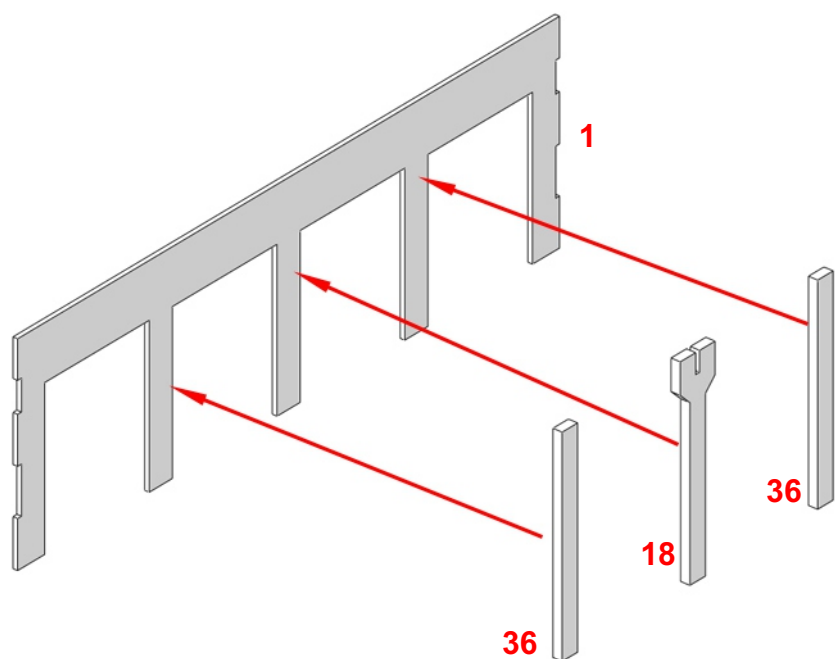

Empezar el montaje con las piezas número 1.  
Por el interior, donde hay unas líneas  
marcadas, que servirán para ubicar  
correctamente las siguientes piezas.  
Pegar las 18 y 36 en las tres patas centrales de  
la fachada.  
En esta cara, encontrará unas líneas  
marcadas que le servirán para ubicar  
correctamente estas piezas y las  
siguientes.

Repetir para la fachada trasera

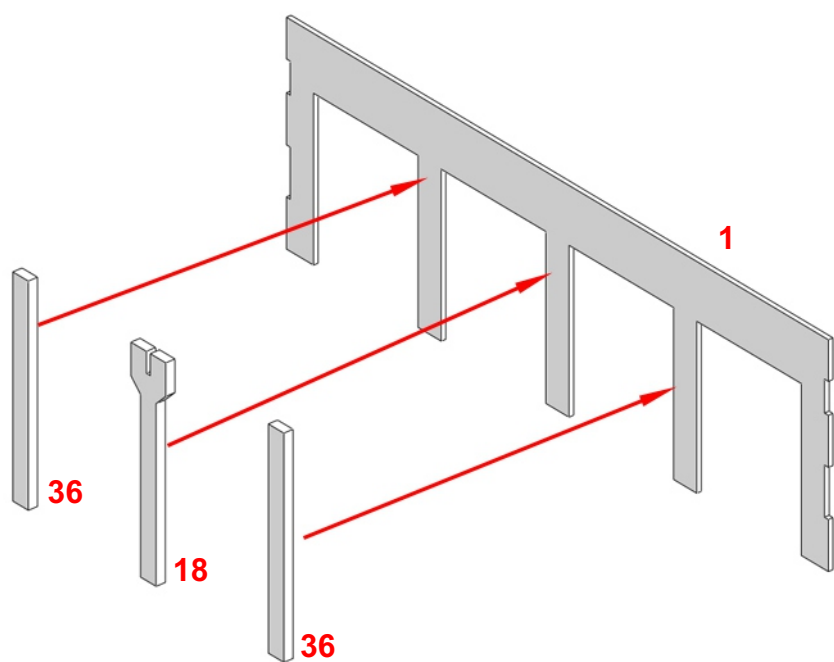

Este es el aspecto que deben tener ahora  
ambas fachadas en su vista interior

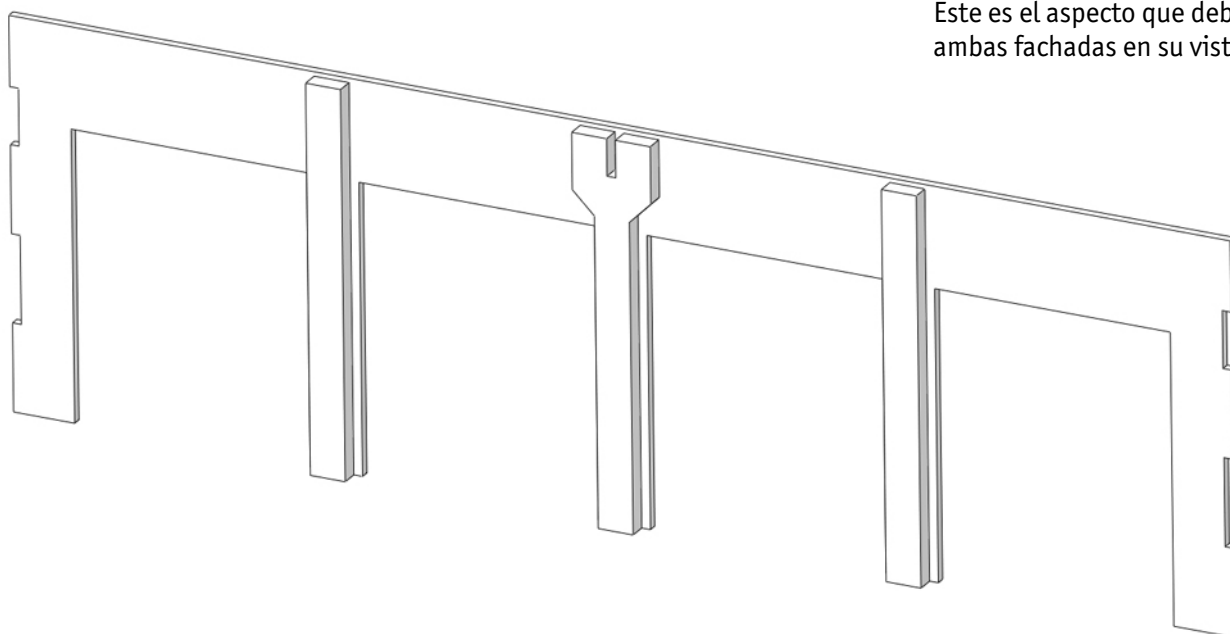

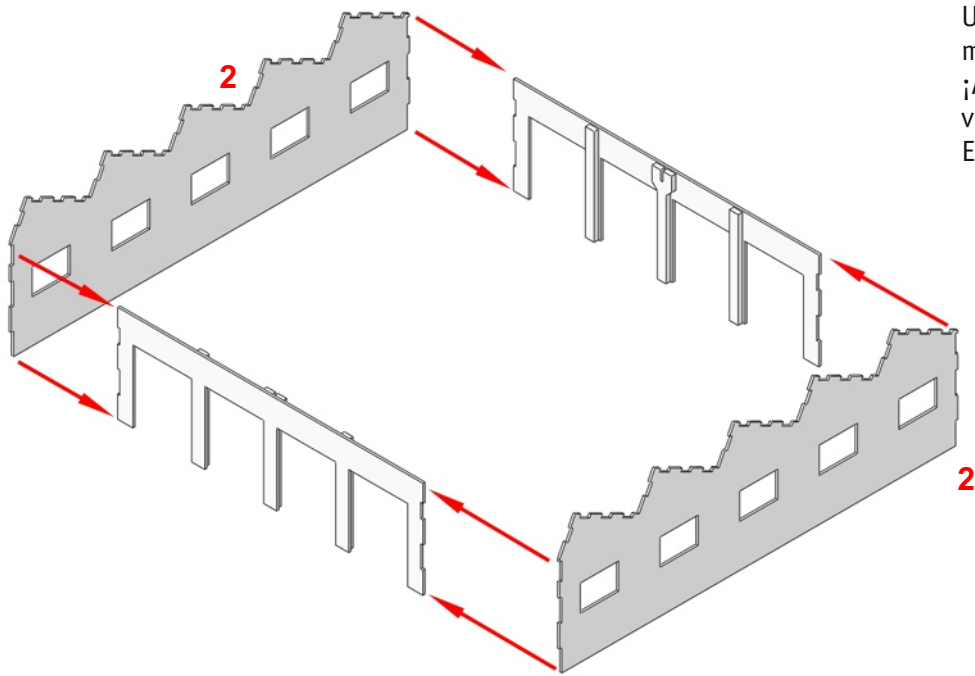

Unir las cuatro paredes perimetrales según muestra el gráfico.  
¡ATENCIÓN!, los marcos grabados en las ventanas de los laterales deben quedar hacia el EXTERIOR del edificio.

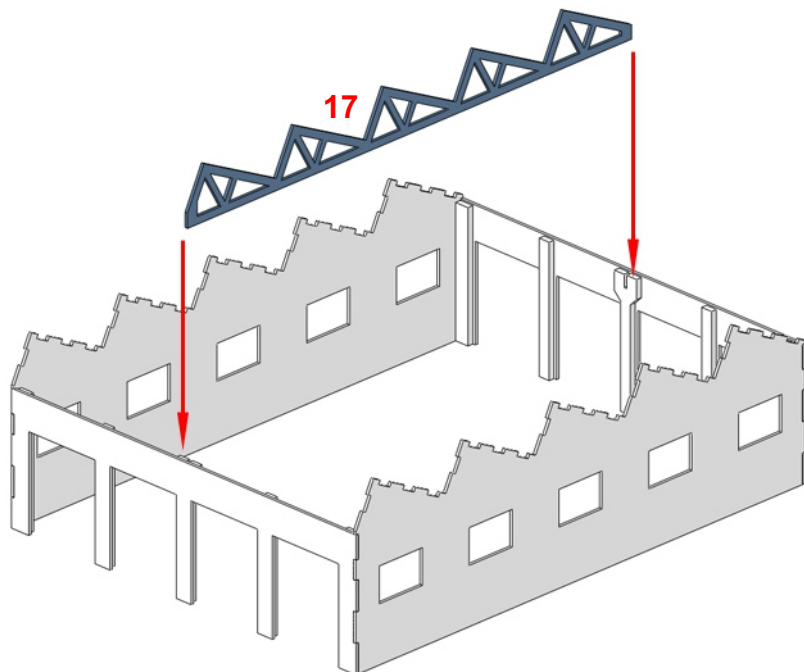
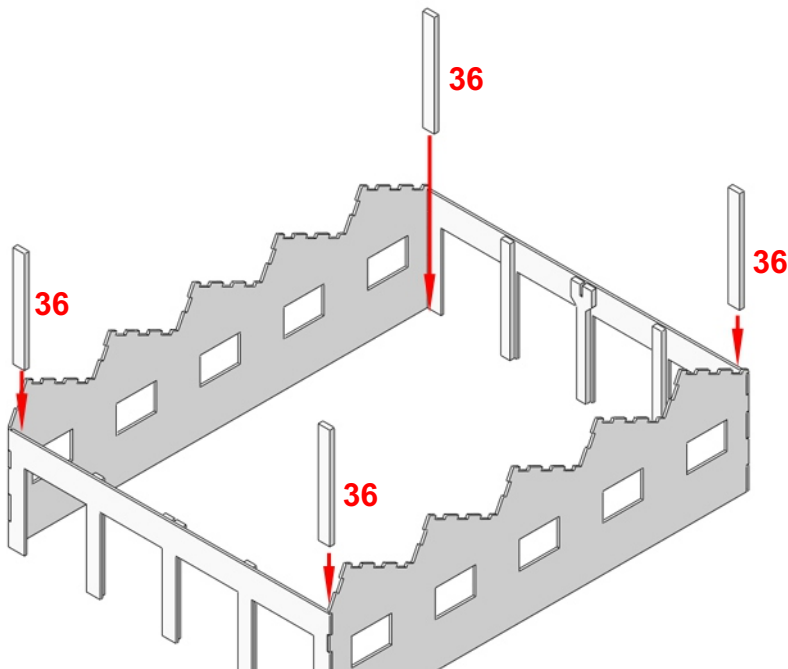

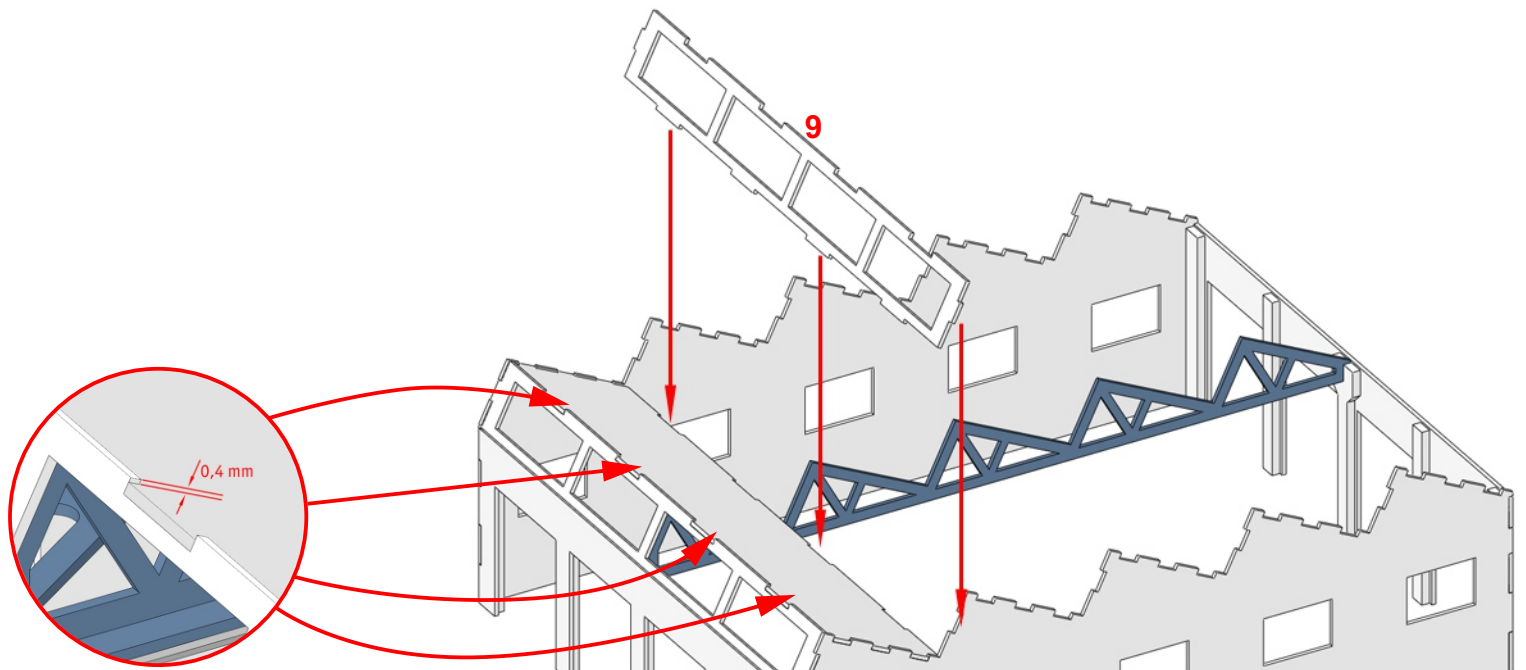
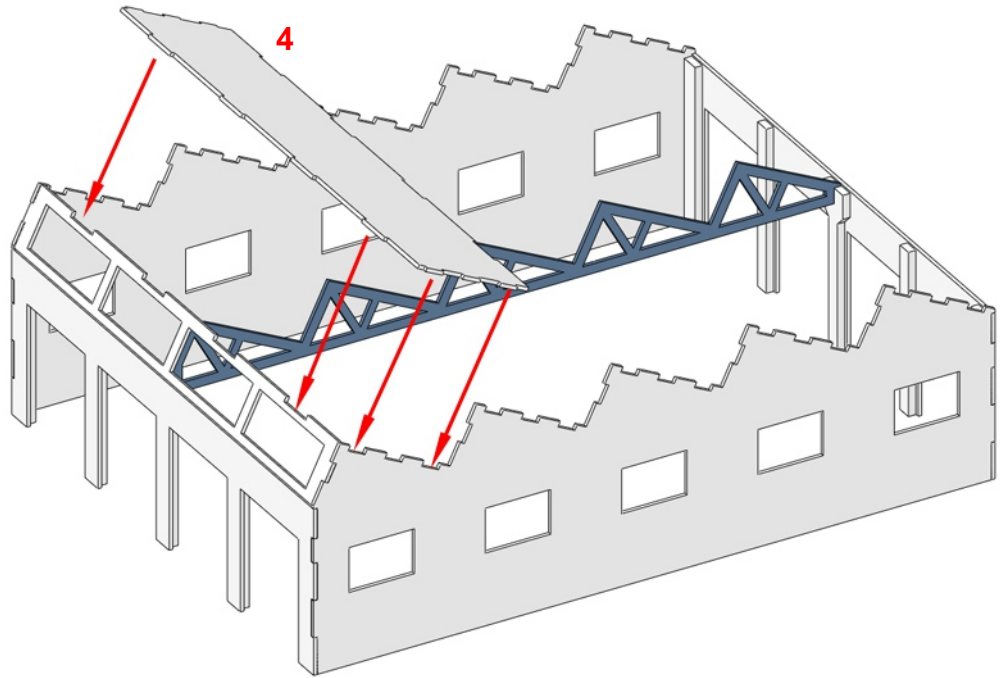
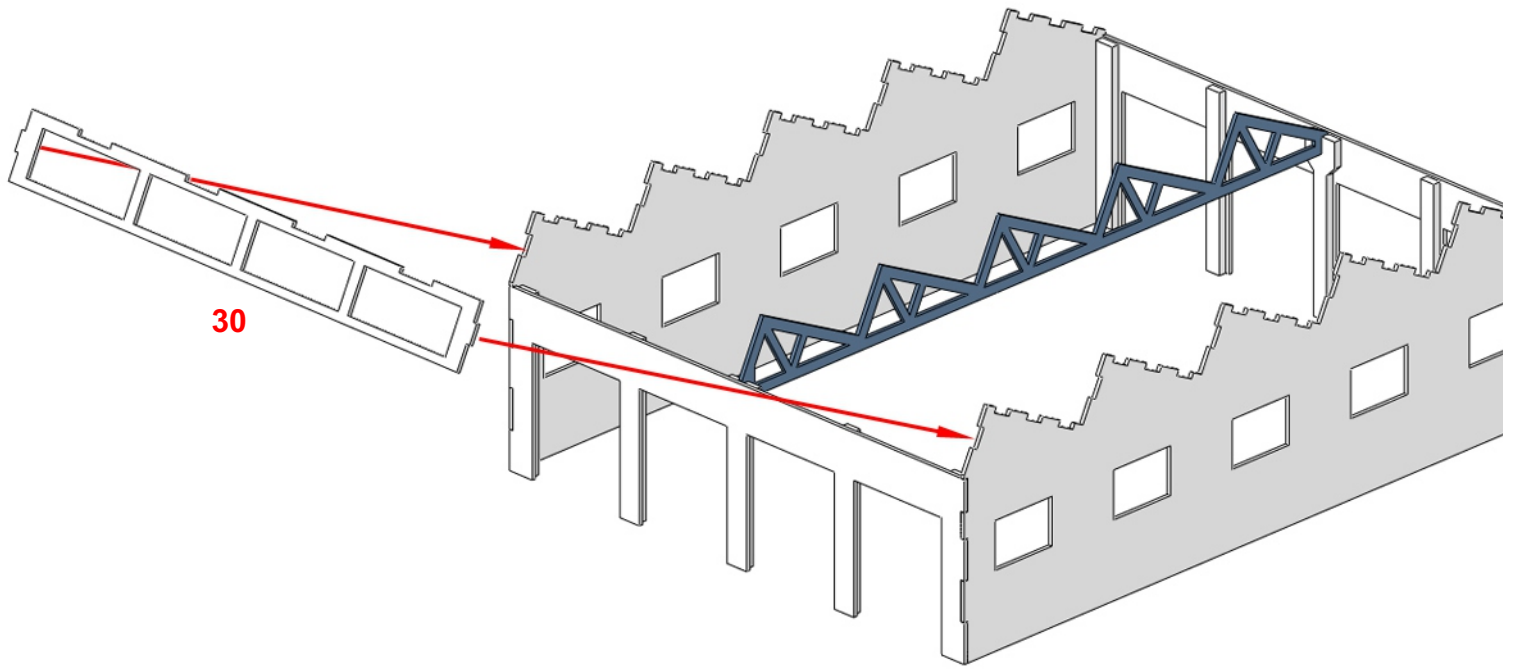



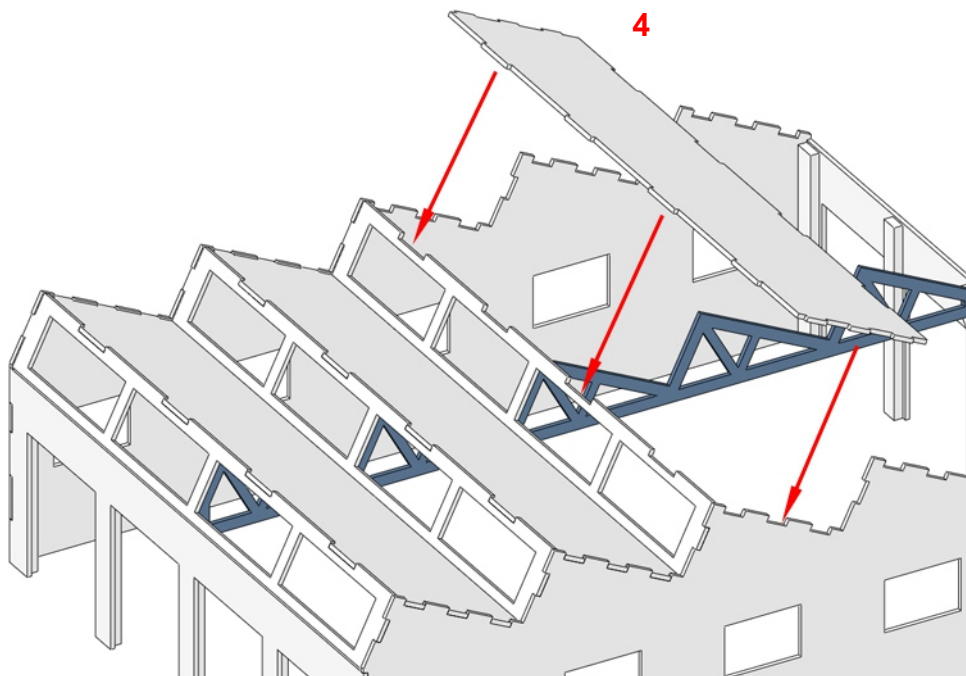
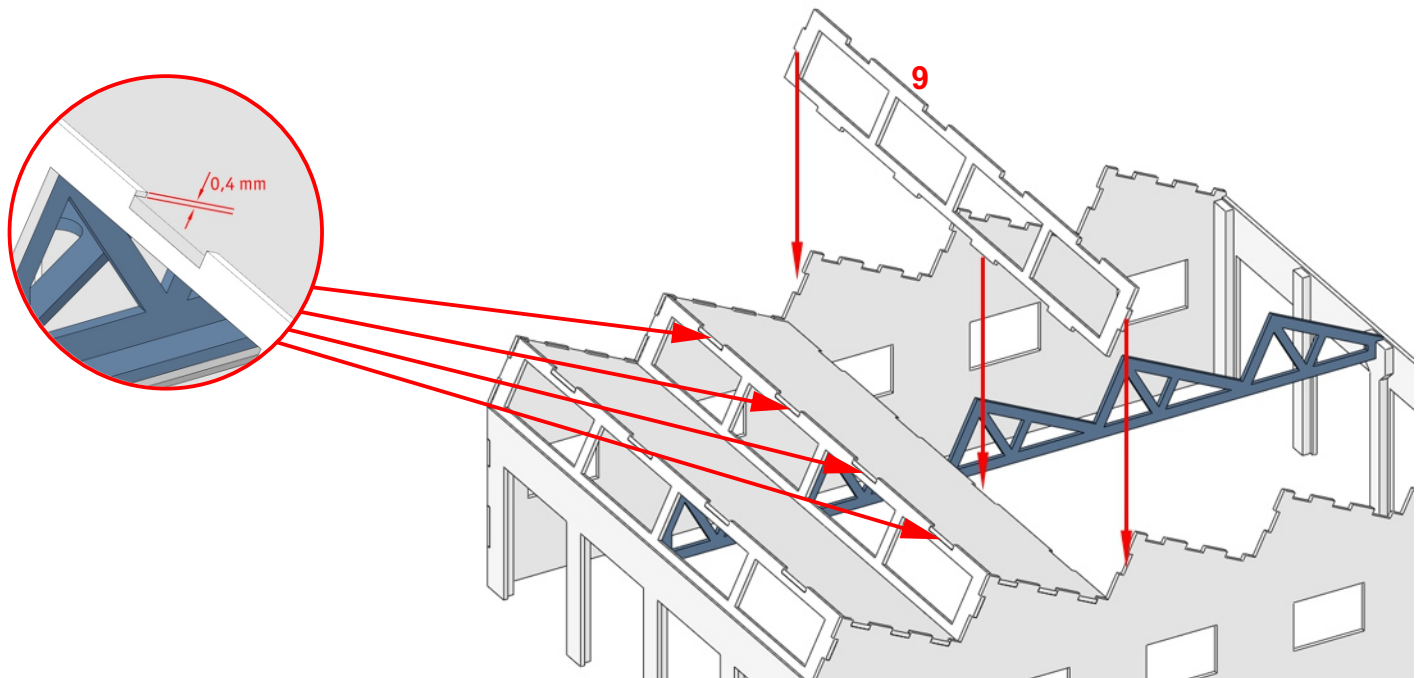
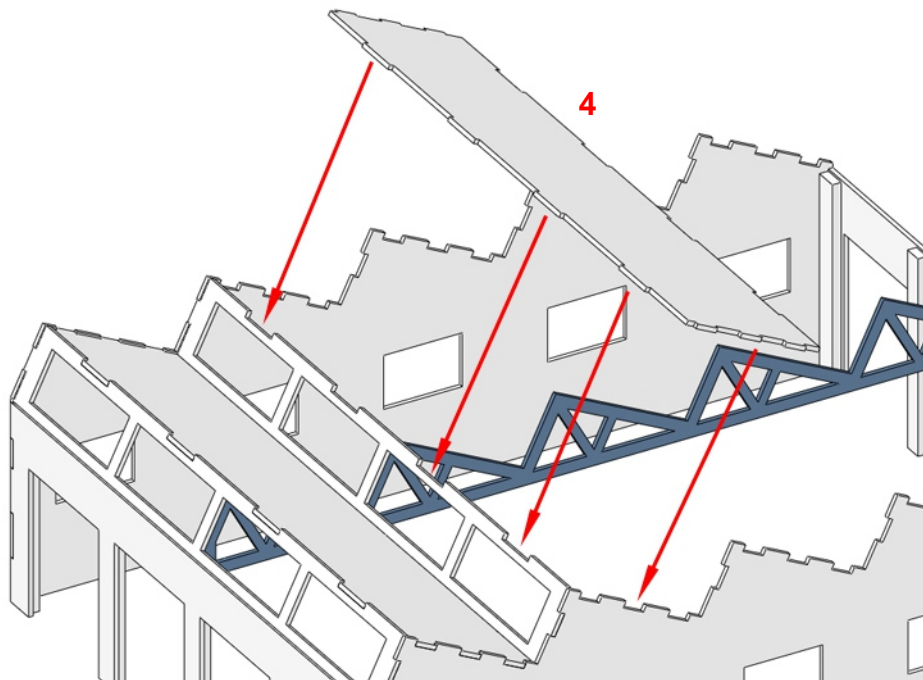

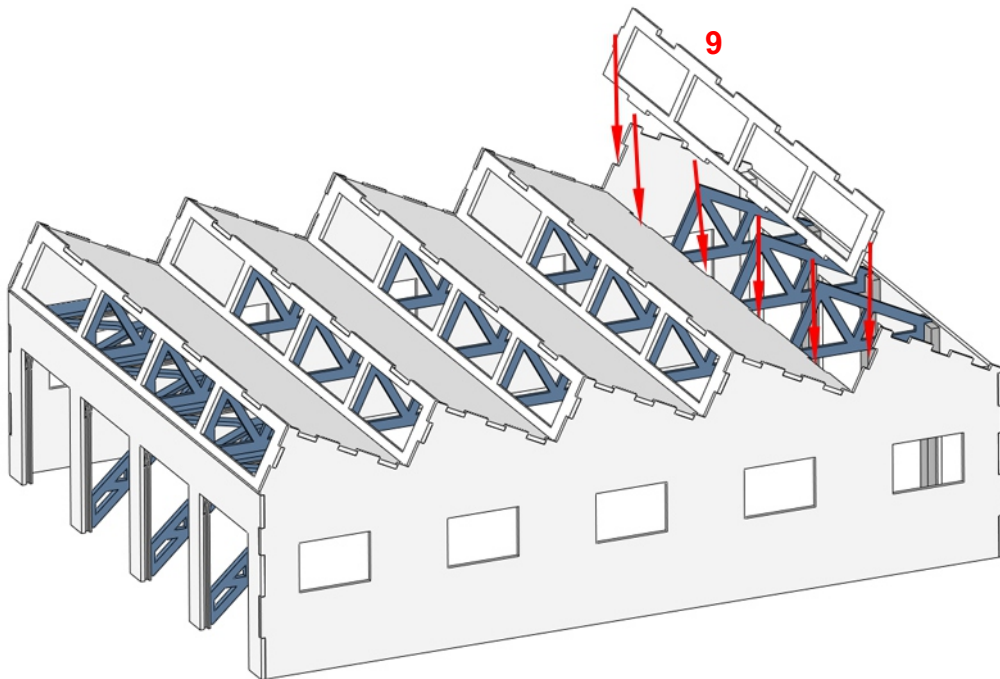
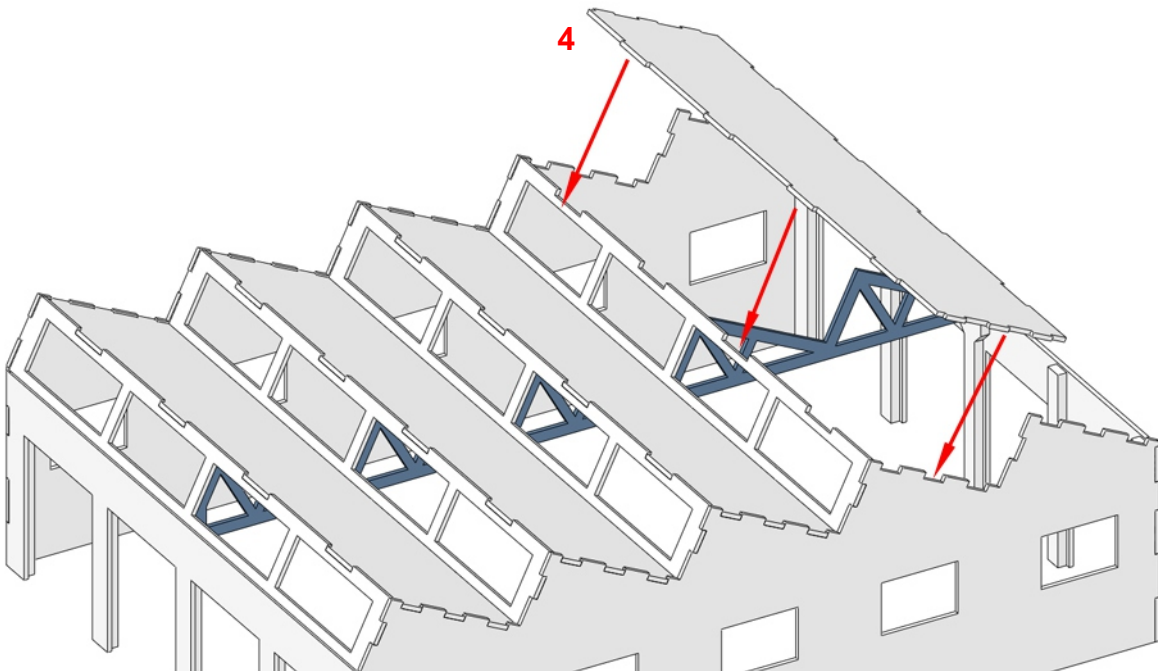
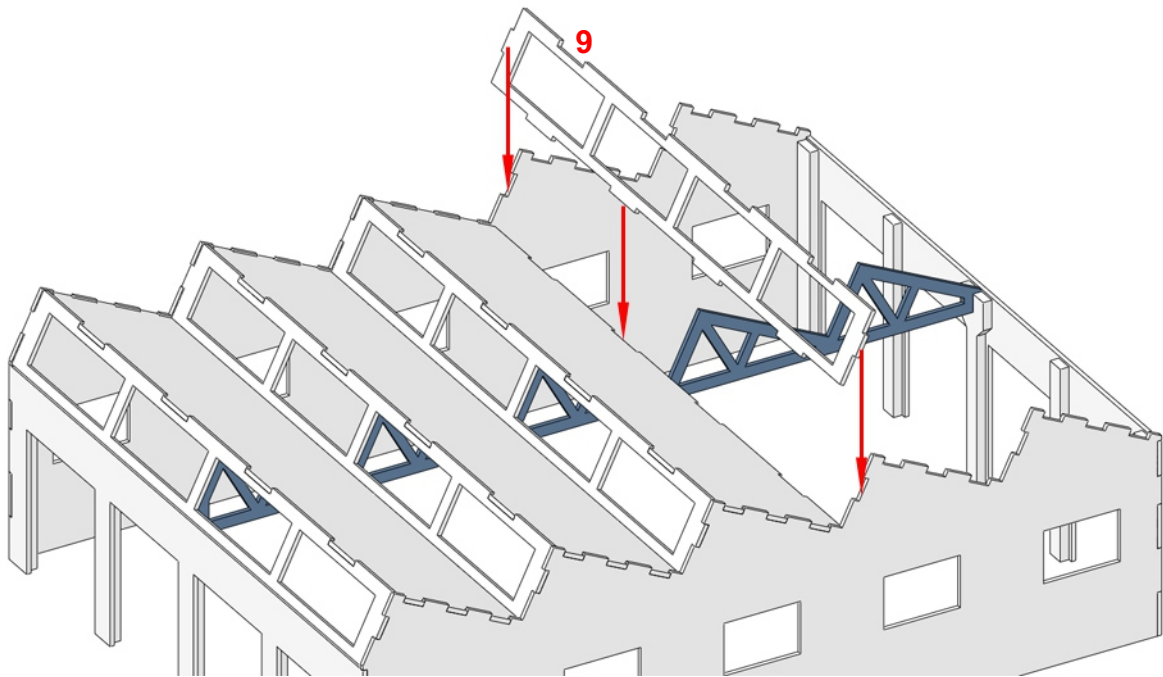

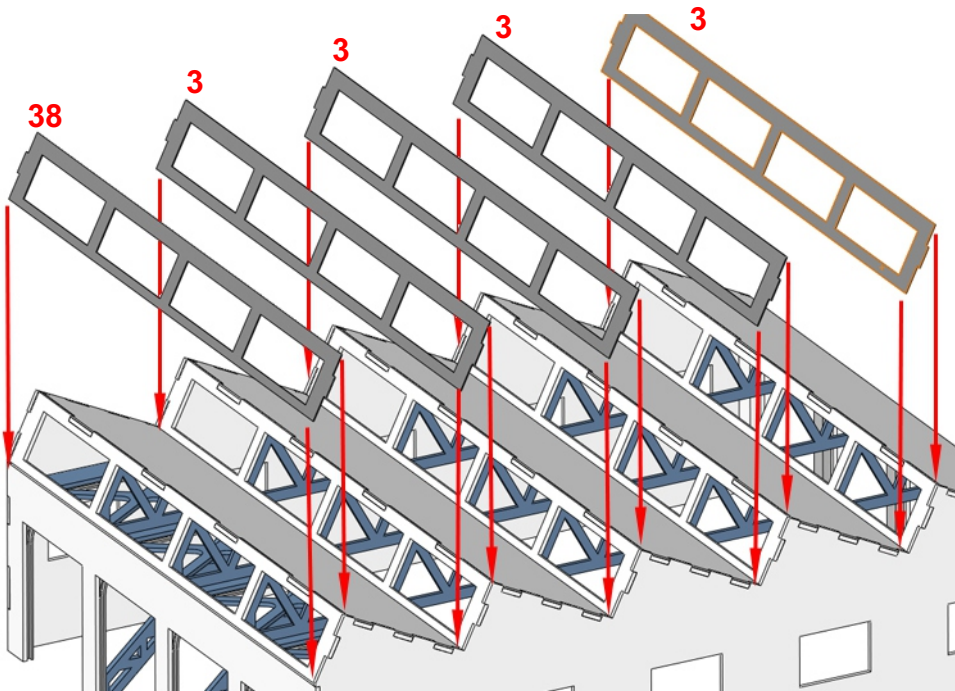
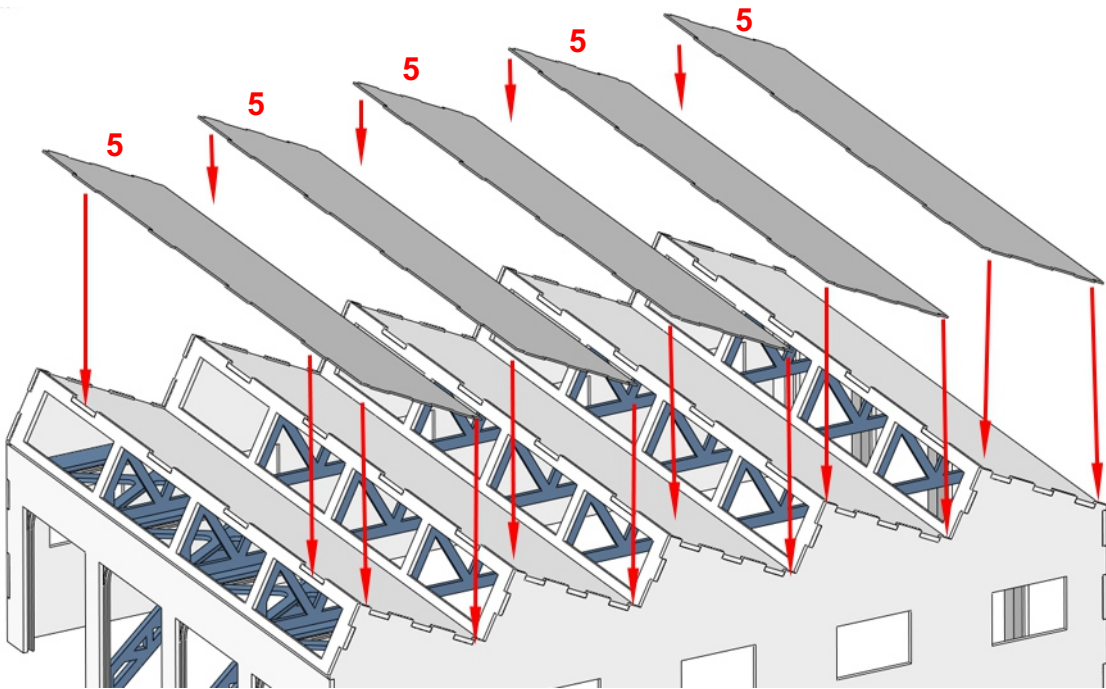
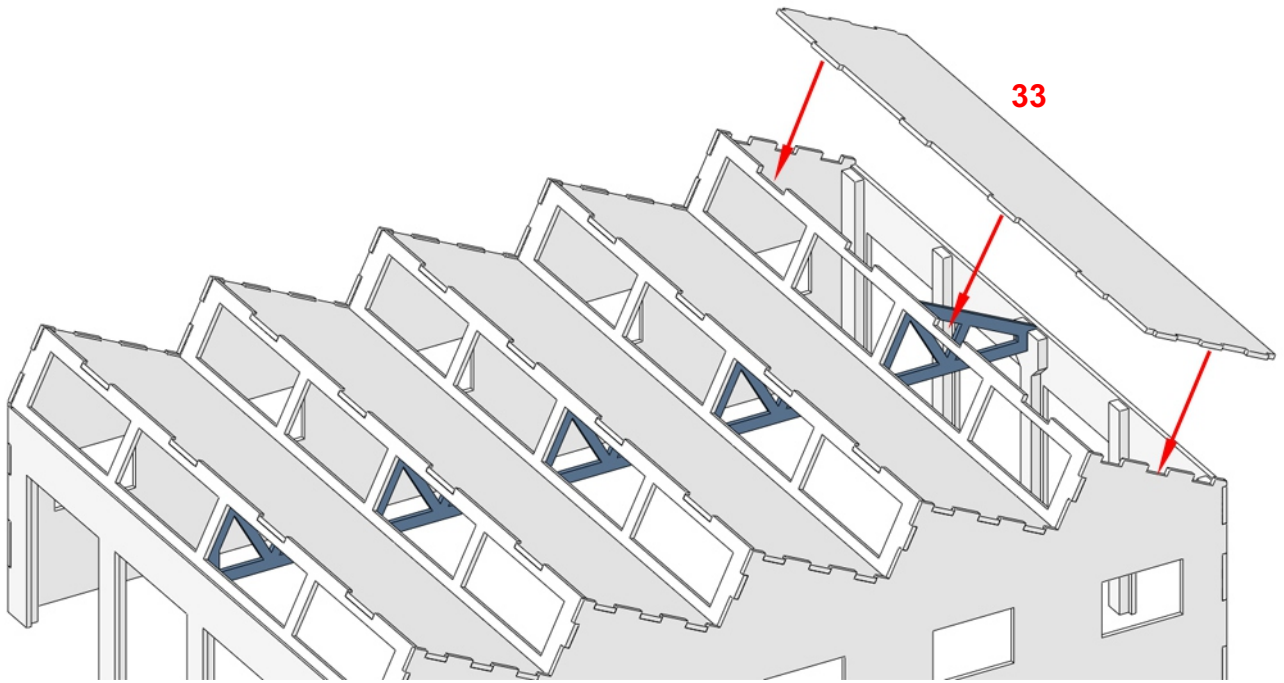



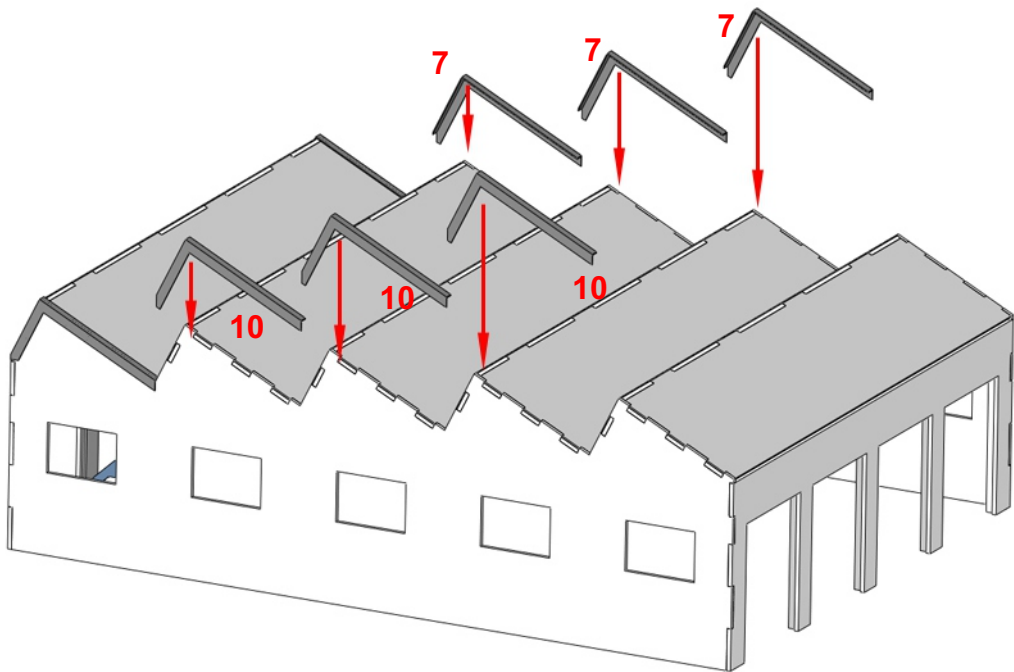
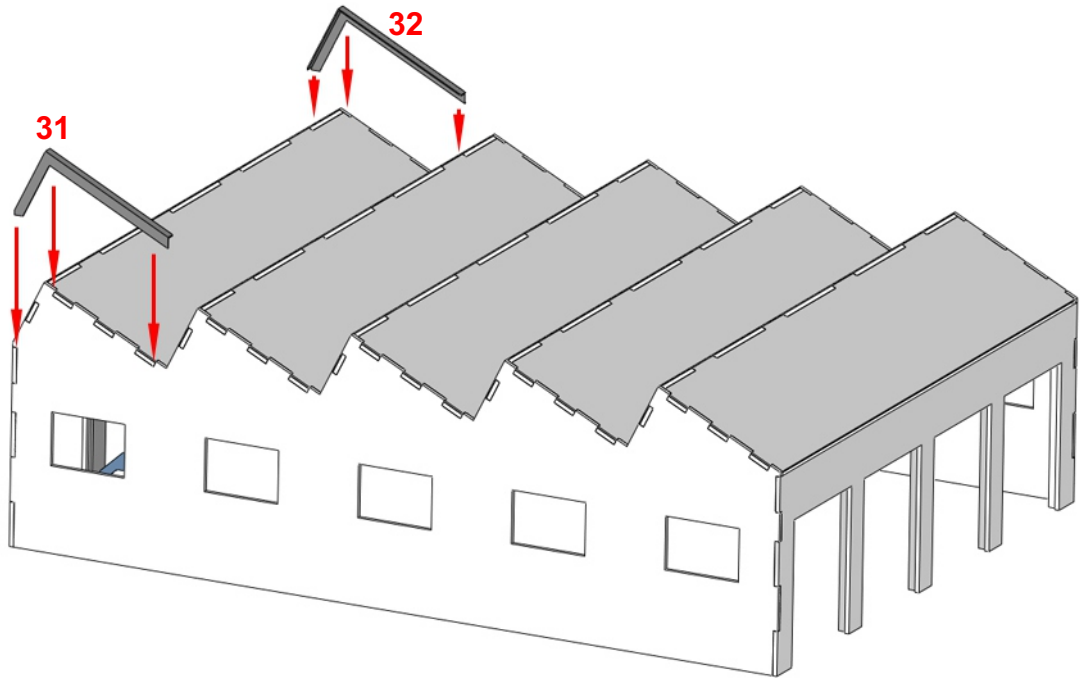
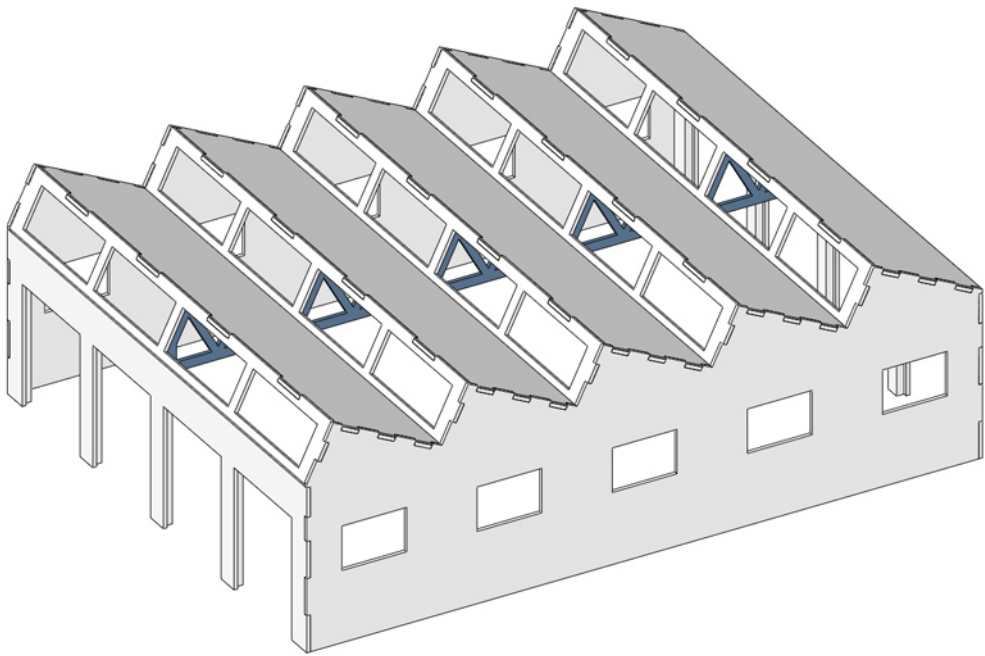

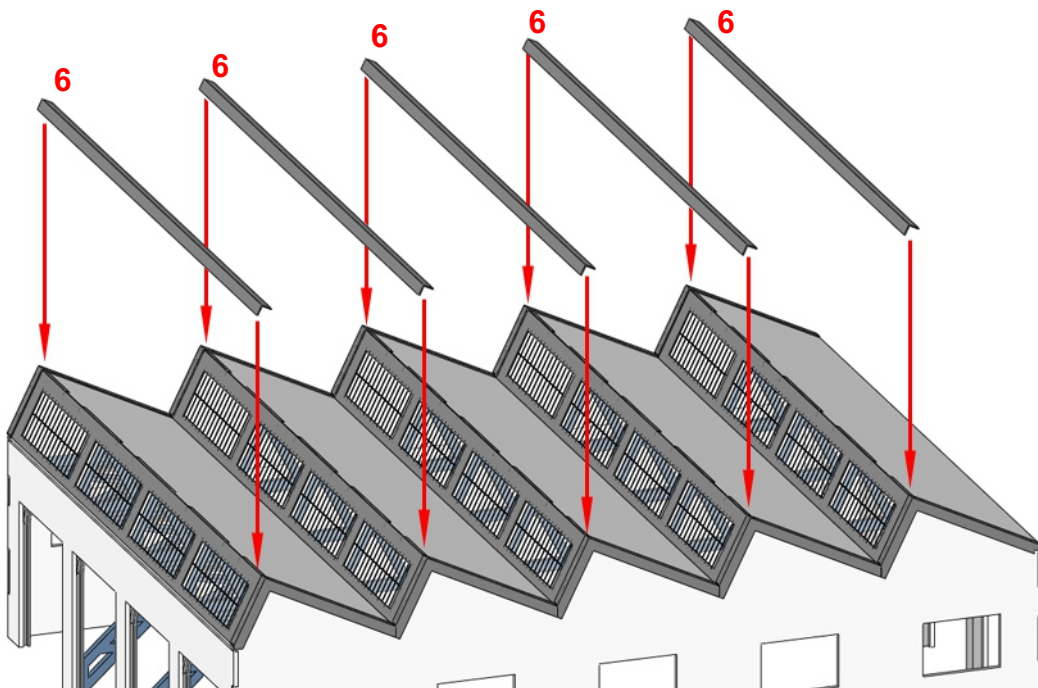
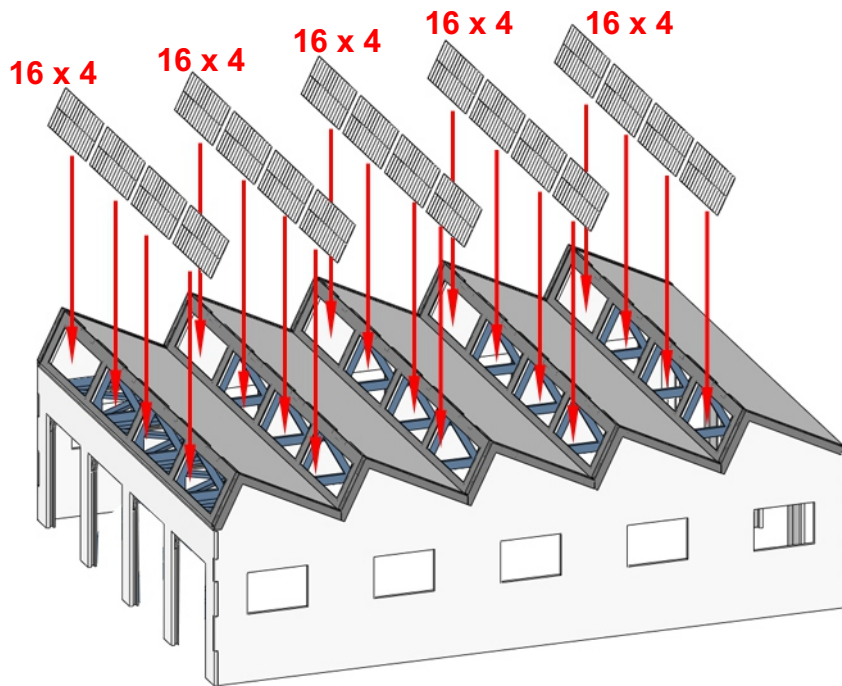
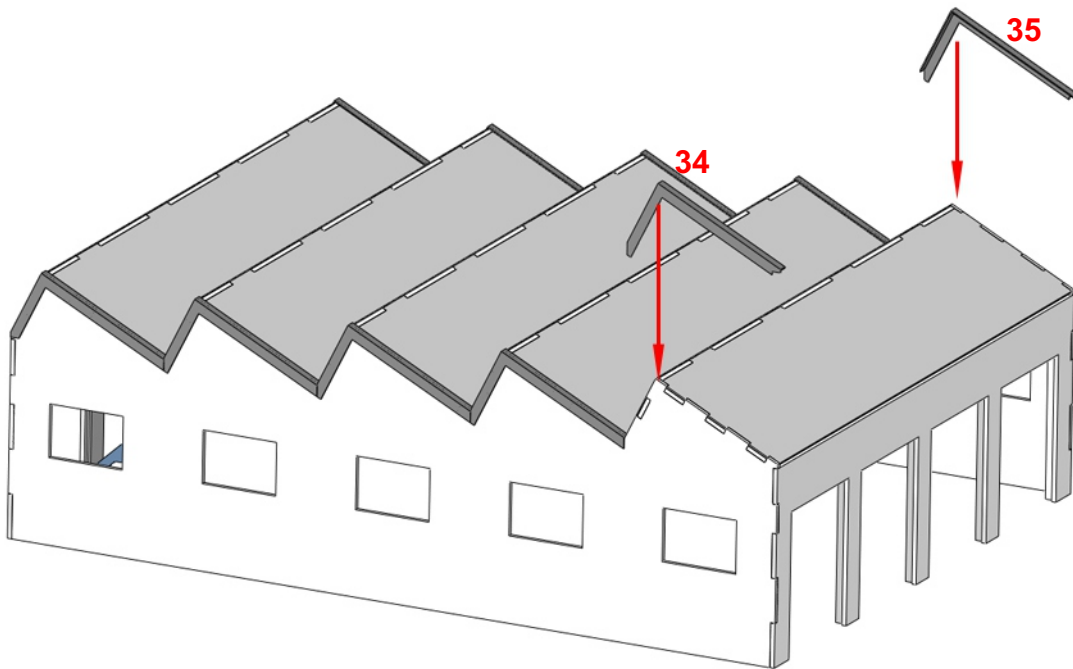

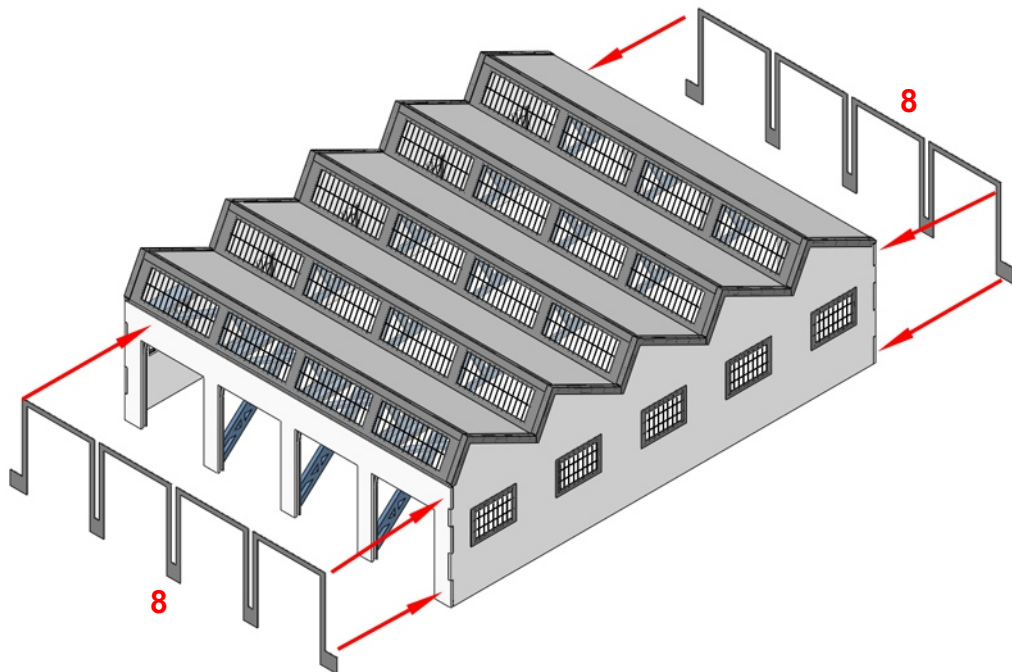
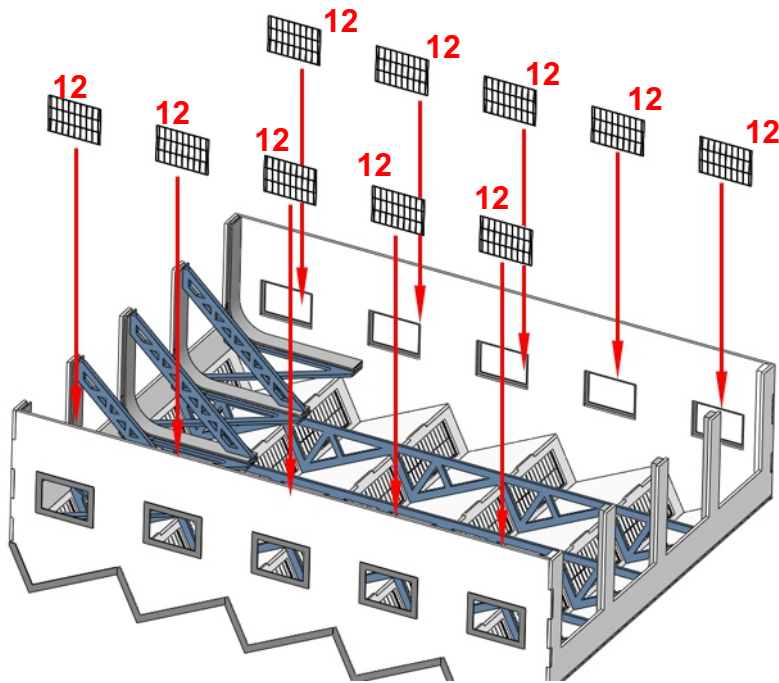
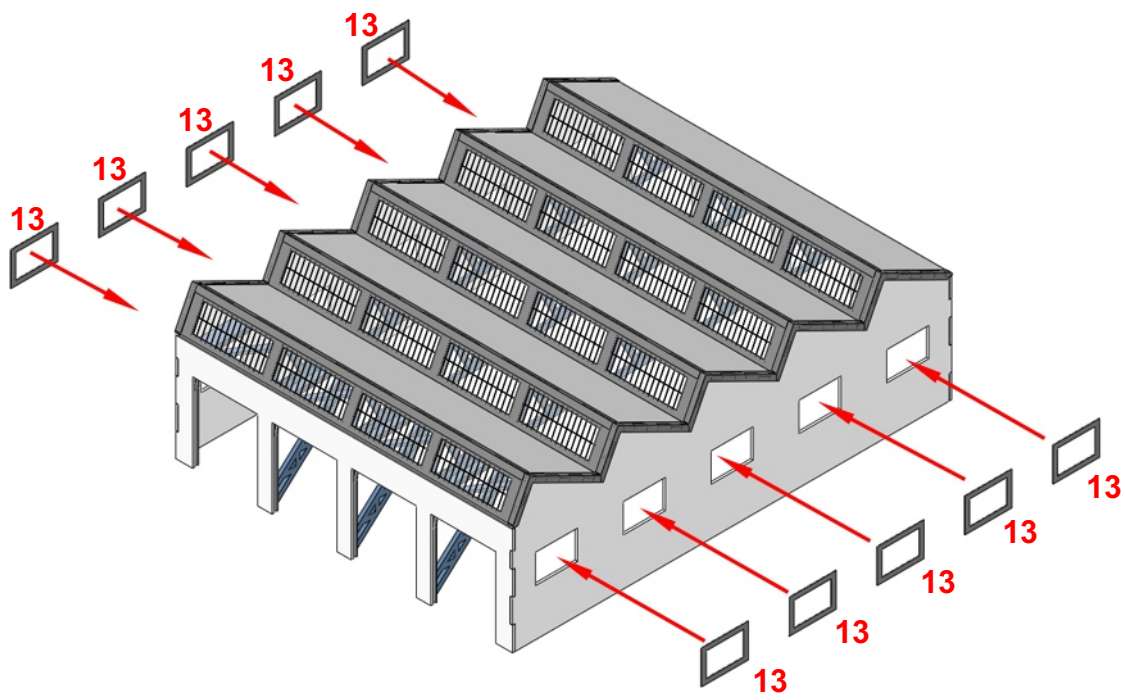



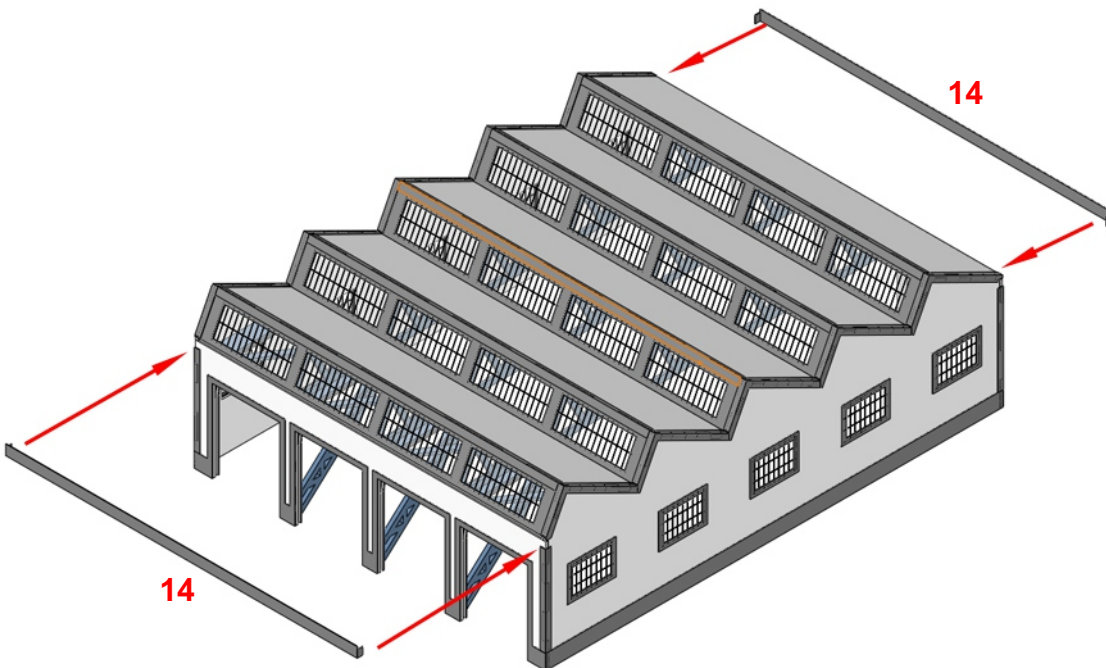
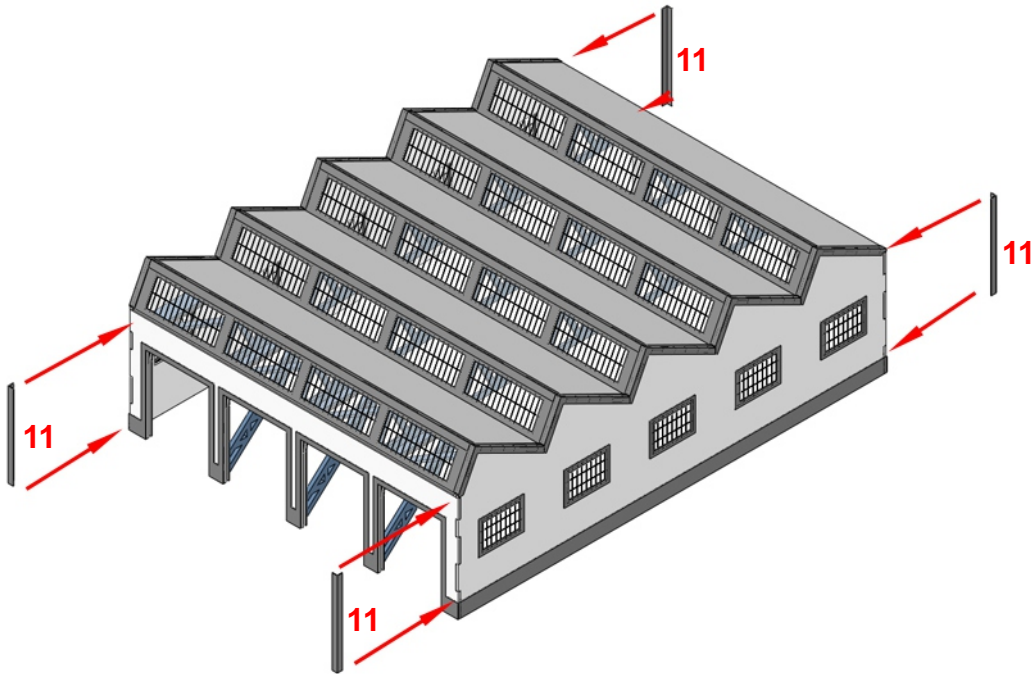
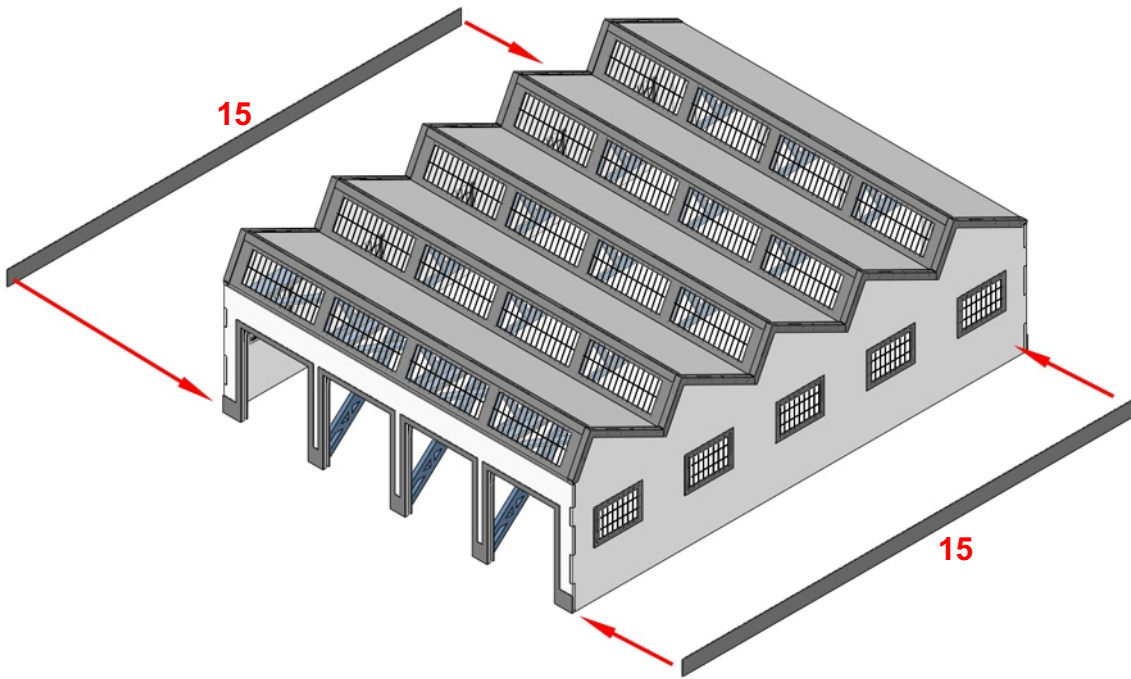

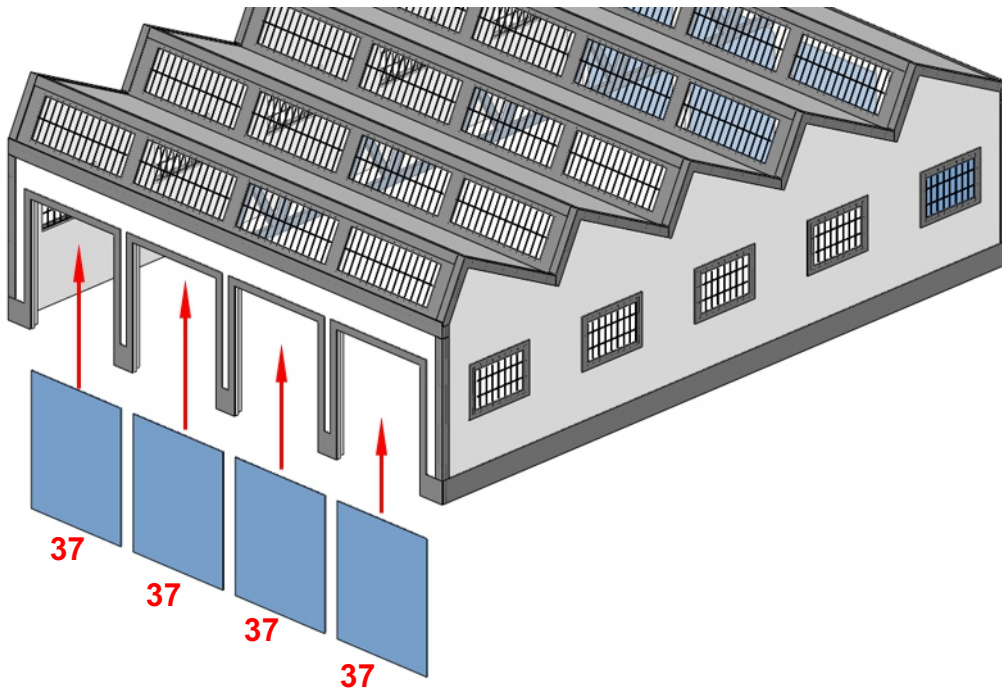
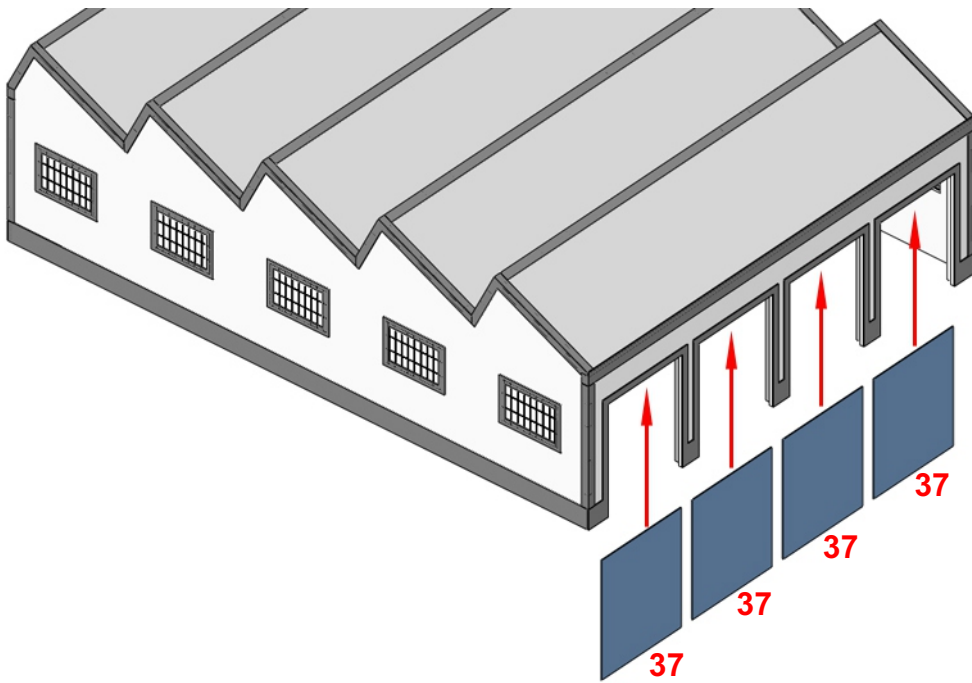

Las puertas de este modelo son fijas, así que sólo pegar las que vayan a tener la entrada o salida cerrada.



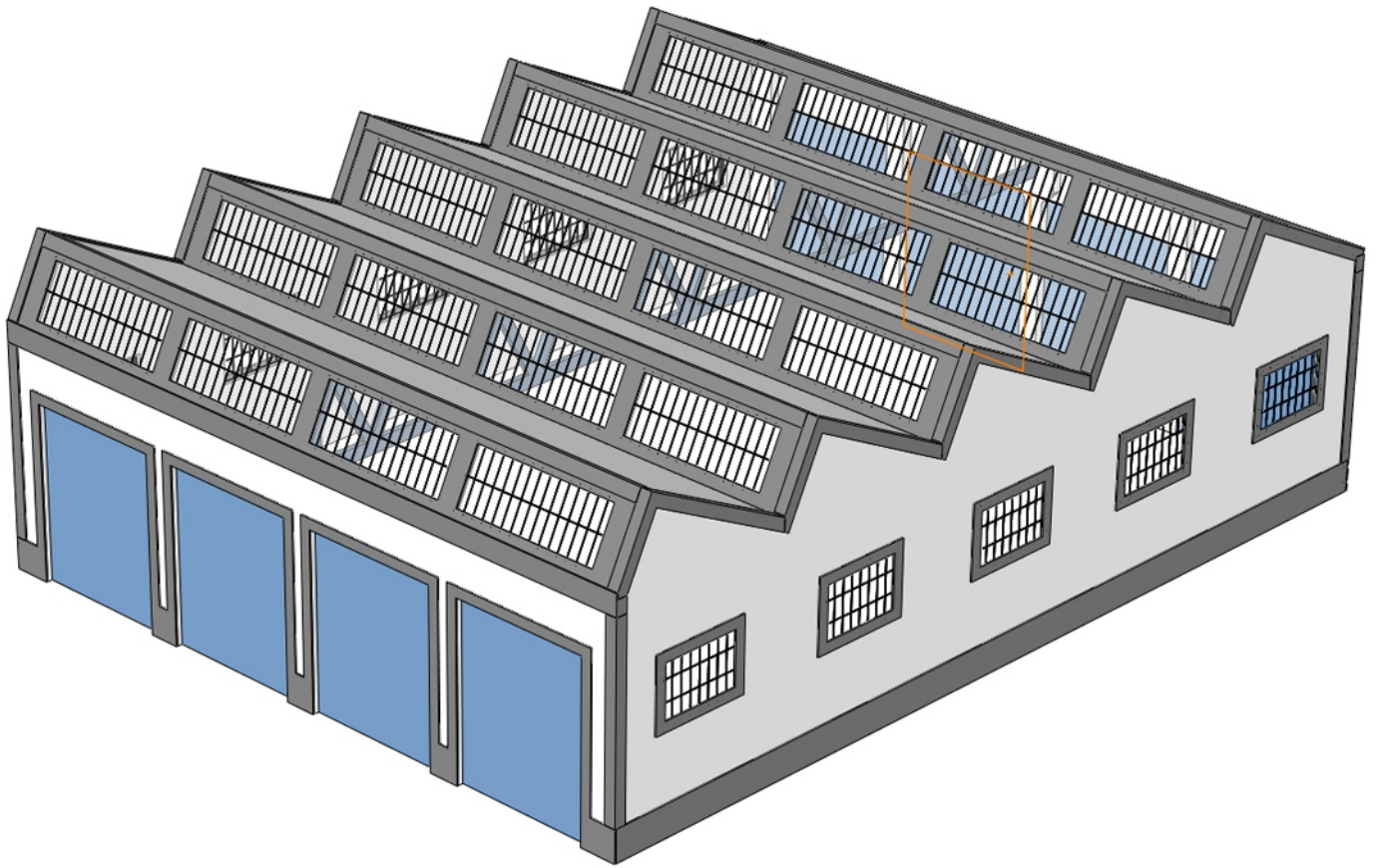

Para respetar el gálibo de las puertas, según normas NEM, es necesario apoyar este edificio sobre la llamada cota G, es decir, el plano superior de la cabeza de las vías.  
Para ello puede rellenar el espacio entre railes, dejando una ranura en la parte interior de los carriles para que circule libremente la pestaña de las ruedas, es lo que se llama vía embebida en losa.  
Para efectuar este trabajo a escala puede hacerse o bien mediante hojas de cartón del grueso de la altura de la vía o bien rellenando el espacio con masilla.

En cualquier caso, si se desea dejar la vía al aire, incluso con balasto puede suplementarse sólo el contorno del edificio.

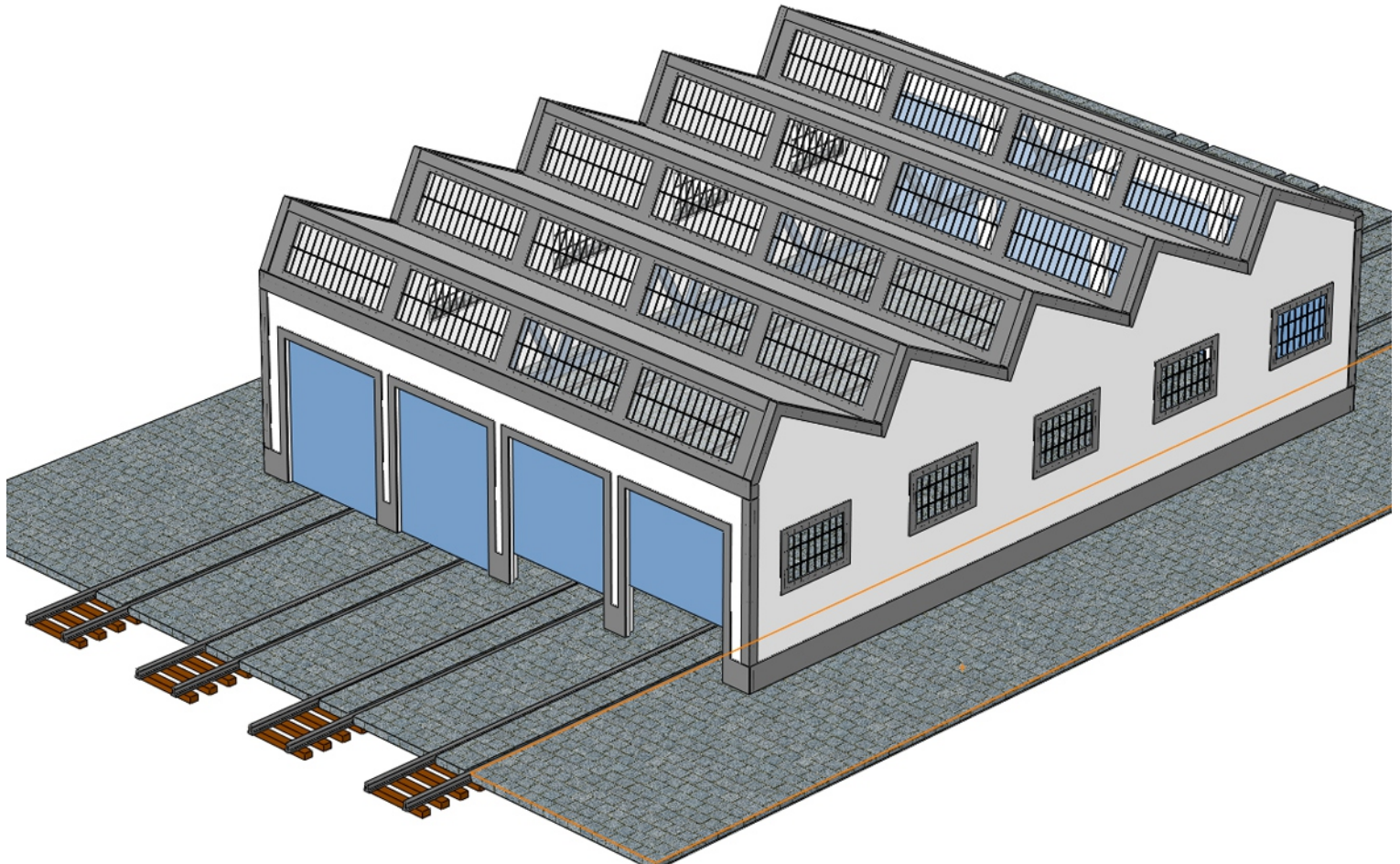

# 3 - Planos

